

TG-600 Operating Instructions

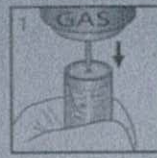

1. Fill LEC:

- Use standard Butane Fuel
- Invert Butane can to allow gravity assist.(Fig 1)
- Allow 5 minutes at room temperature for fuel to stabilize before use.

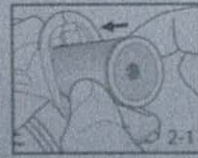

2. Insert LEC into Chamber:

- Insert LEC into TG600 chamber.(Fig. 2-1)
- Insert with green flat side toward inside of gun.
- Replace the chamber cap.(Fig. 2-2)



3. Insert Glue Stick:

- Place glue stick in rear chamber.(Fig. 3)
- Push forward until glue stick stops.
- If using short sticks or for continuous use, insert 2 sticks, one behind the other
- Wait several minutes after inserting for glue to reach flow temperature.



4. Advance Glue Stick:

- Pull lever back gently towards handle. (Fig. 4)

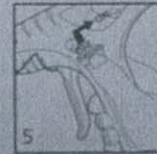

5. Turn on fuel:

- Push up fuel control wheel until spring locks in place.(Fig. 5)
- Turn wheel to right.

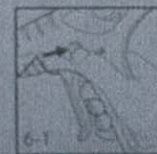

6. Ignite:

- Push red button until ignited(Fig. 6-1), indicated by a red glow.(Fig. 6-2)
- Allow 3-5 minutes to allow glue to soften.



7. Dispense Glue:

- Gently squeeze lever handle until desired amount of glue dispensed.

8. Rest in Stand:

- Pull down metal folding stand.
- Position gun in stand when not actively using.



9. Turn Off Unit:

- Rotate Fuel Control Wheel (Fig. 5) left until the end and it snaps into locked position.
- Avoid clogging/dripping after use by pulling back the glue about 1"

NOTE:

- After tool cools and is used at a later time, it is normal for up to 1" of hardened glue to be dispensed before hot glue flows from nozzle.

TECHNICAL SPECIFICATIONS

Length	230mm (9.1")
Weight	100mm (3.9oz)
Weight (when gas filled)	100 g
Temperature	100° - 200°C(212° - 444°)
Gas consumption capacity	40 ml (1.4oz)
Operating capacity (with gas filling)	100 minutes



LEC-10
Refillable Type
Liquid
Energy
Cell™
(Green cap-color)



LEC-11
Disposable Type
Liquid
Energy
Cell™
(Red/Green cap-color)



7 42286 04006 5

Made in Taiwan

