

# ET2607

## EGR Valve Activator / Tester

### Instruction Manual



*Thank you for purchasing this product. Manufactured to a high standard this product will, if used according to these instructions and properly maintained, give you years of trouble free performance.*

## Safety

---

**WARNING: Risk of Electrocution.** Keep hands and fingers away from metal probe clamps and relay insertion points

**CAUTION:** Read, understand and follow Safety Rules and

- Operating Instructions in this manual before using this product.
- Do not attempt to repair unit. There are no user serviceable parts.
- Do not expose the unit to extreme temperatures or high humidity
- Do not use the unit if it is wet or damaged
- Do not apply more than the rated current and voltage
- Do not operate with the case open



This symbol, adjacent to another symbol or terminal, indicates the user the user must refer to the manual for further information.



This symbol, adjacent to a terminal, indicates that, under normal use, hazardous voltages may be present



Double insulation

### General Safety

- **WARNING!** Ensure Health and Safety, local authority and general workshop practice regulations are adhered to when using tools.
- **DO NOT** use this unit if damaged.
- Maintain tools in good and clean condition for best and safest performance.
- Ensure that a vehicle which has been jacked up is adequately supported with axle stands.
- Ensure that all tools are removed from the engine bay upon completion of the job.
- Wear approved eye protection.
- Wear suitable clothing to avoid snagging. **DO NOT** wear jewelry and tie back long hair.
- Keep children and unauthorised persons away from the work area.
- **DO NOT** attempt to start engine or move vehicle whilst in gear.

## 🔧 Introduction

---

This 12V EGR Valve Activator / Tester (ET2607) is used to allow the Exhaust Gas Recirculation (EGR) valve to be operated in situ. It can be held in the open position to aid cleaning of carbon deposits or switched open / closed to check operation. This unit is supplied with a range of connectors to suit a range of valves.



### **Specifications:**

Model Number: ET2607

Power Supply: 12V vehicle power supply

Continuous Open / Close Cycle time: 90 seconds

Dimensions: 140mm L x 68mm W x 36mm D

Weight: 200g

## 🔧 Operating Instructions

---

### 1. Preparation

1.1. Fig.1: Remove multi-pin plug (1) from EGR valve body (2).

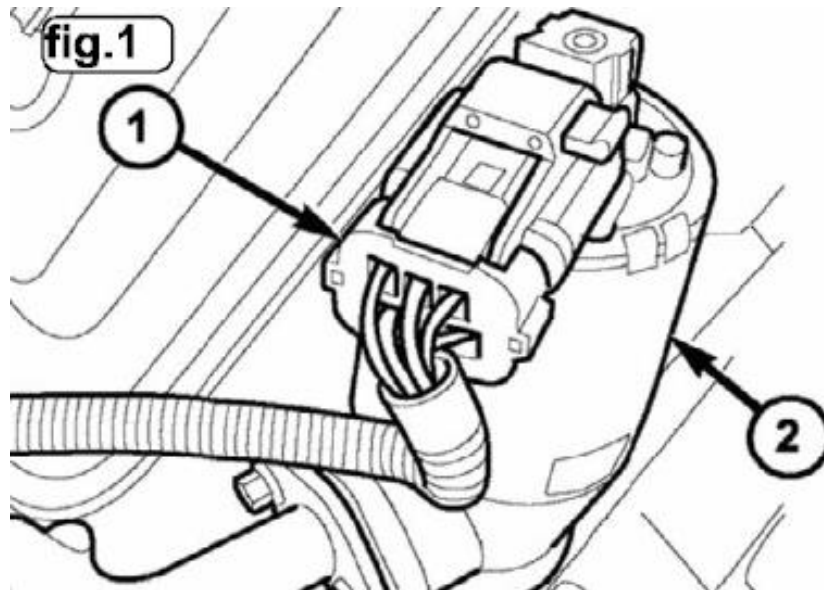

1.2. Fig.2: Select appropriate lead for vehicle being worked on (see workshop manual / data book for details). Multi-pin, 1.2mm and 2.8mm connections are included.

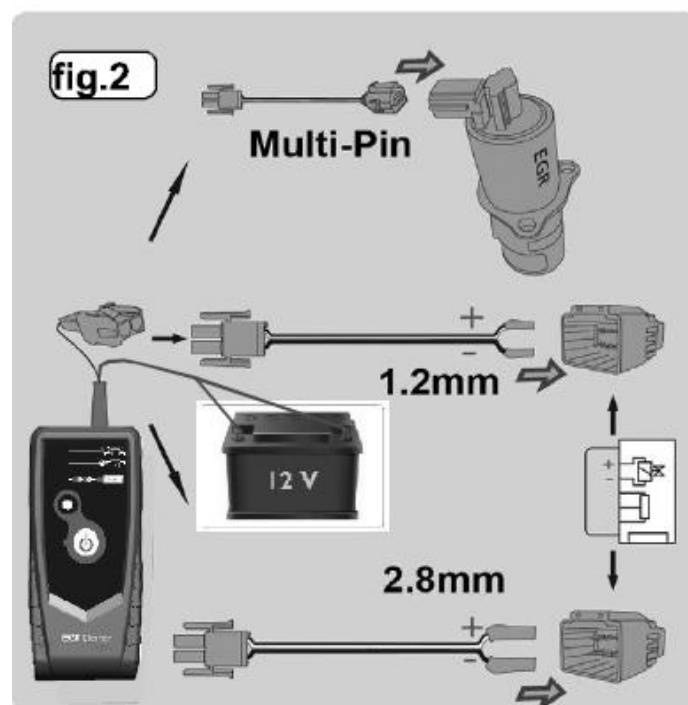

1.3. Connect lead to EGR valve socket. Black lead = negative, black & white lead = positive.

1.4. Connect lead to ET2607 test unit.

1.5. Connect tester to 12V DC power source.

## 2 Short Test

2.1. Fig.3: Press the test button for less than 1 second. This will either open or close the valve, depending on initial position.

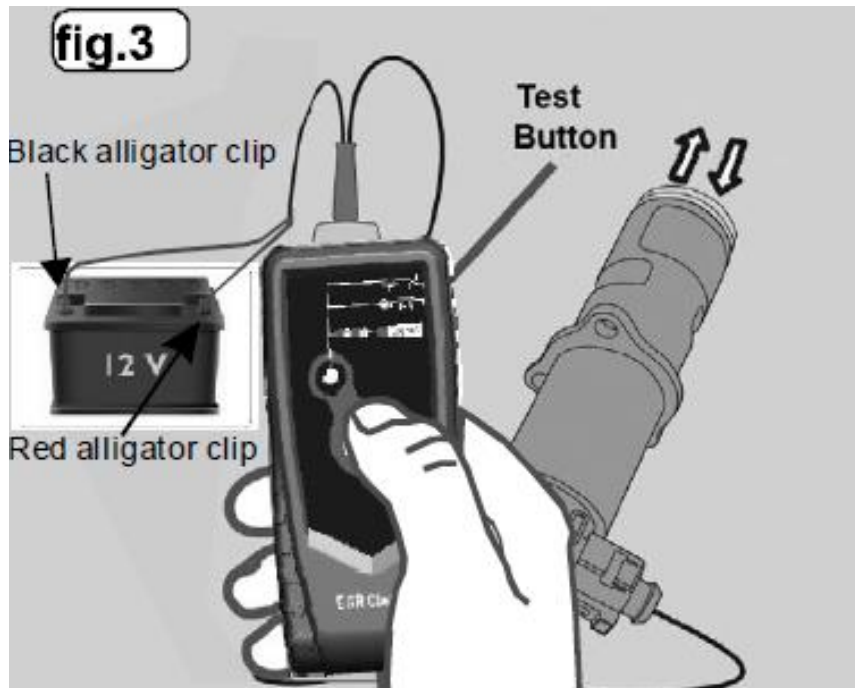

2.2. Each subsequent short press of the test button will open or close the valve, establishing if the valve is obeying commands from the engine control unit correctly.

2.3. A single click from the EGR valve will be heard each cycle.

2.4. If the valve has been removed from the vehicle, carbon can be removed manually with the valve held open.

## 3. Self-cleaning cycle

3.1. Press the test button for more than 1 second. This will initiate a continuous test cycle lasting 90 seconds, during which time the valve will repeatedly open and close. This will free accumulated carbon deposits from the valve and seat.

3.2. A continuous clicking sound will be heard from the valve.

3.3. During the test the indicator light will flash red.

3.4. At the end of 90 seconds, a steady green light will show for 3 seconds. When this goes out, the cleaning cycle is complete.

## 4. Fault indication

4.1. If the unit is connected to a 12V power source without the test leads connected, an alarm will sound continuously indicating the presence of an open circuit.

4.2. Similarly, if the tester is connected to a faulty EGR valve the alarm will sound. This indicates that the valve unit needs replacement.

## 5. Disconnection

5.1. When test is completed, disconnect tester from the 12V DC power source.

5.2. Disconnect test lead from EGR valve.

5.3. Reconnect multi-pin plug from engine control unit to EGR valve socket.

5.4. Remove all tools from engine bay before starting engine.

## ☞ Maintenance

---

### ☐ WARNING!

- DO NOT attempt to repair or service unless you are qualified to do so and have the relevant calibration, performance test, and service information. To avoid electrical shock or damage to the tester do not get water inside the case.
- Periodically wipe the casing and flying leads with a damp cloth and mild detergent. DO NOT use solvents.
- After each use wipe clean the crocodile clips with a lightly oiled cloth.
- DO NOT store in a place of high humidity or high temperature.

---

**NOTE:** It is our policy to continually improve products and as such we reserve the right to alter data, specifications and component parts without prior notice.

- **IMPORTANT** : No liability is accepted for incorrect use of this product.
- **WARRANTY:** Guarantee is 12 months from purchase date, proof of which will be required for any claim.